

# flexible spaces all the right places...



...Puritas Business Centre I  
4455-4505 & 4517-4521 West Parkway, Cleveland, Ohio



...Puritas Business Centre III A & B  
13929-13981 Industrial Parkway, Cleveland, Ohio

**“Flexible Spaces in All the Right Places”** is what Fogg had in mind when designing their large portfolio of office, industrial and office/warehouse (flex) properties. Strategically located near major freeways in northeast Ohio, Fogg’s properties offer flexible floor plans, truck access and lease terms, as well as expansion opportunities for their growing customers.

Located in the I-480/I-71 corridor on the west side of Cleveland, Ohio, Puritas Industrial Park is easily accessible from I-480, I-71, and West 150th Street. Fogg’s Puritas Industrial Park properties offer office/warehouse space ranging from basic small efficient spaces, to large distribution and manufacturing space in the heart of Cleveland’s west side industrial market.

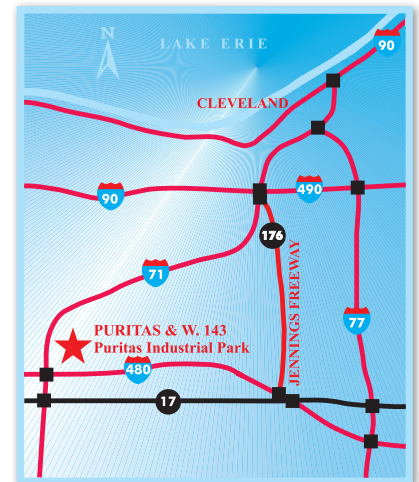

“I have worked with various property managers finding corporate expansion facilities for the last twenty-five years in five different States and by far Ray Fogg Corporate Properties management services has the smoothest operations and the nicest people to work with.”

- E & R Industrial

“We have been pleased with the responsiveness of the entire Fogg organization. They are professional and a straightforward business partner.” - Virginia Tile Company



216.351.7976  
[fogg.com](http://fogg.com)

# STANDARD BUILDING SPECIFICATIONS

## Puritas Business Centre I & Puritas Business Centre III A & B

The following information is a general description of the project. Please see the Individual Space Specifications for more details on each available space.



### LOCATION & ACCESS

#### Shared Features

- 6 miles from downtown Cleveland and 2 miles from Cleveland Hopkins International Airport
- Access to I-480 and I-71 at West 130th St. and West 150th St.

#### Puritas Business Centre I

- 3.45 acre site south of Puritas Rd. at West 143rd St. in Cleveland, Ohio

#### Puritas Business Centre III A & B

- 9.45 acre site at the junction of West Parkway and Industrial Parkway in Cleveland, Ohio

### PROPERTY DATA

- Puritas Business Centre I: 56,058 SF
- Puritas Business Centre III A: 78,320 SF
- Puritas Business Centre III B: 60,320 SF

### EAVE HEIGHT

- 20'

### COLUMN SPACING

- Puritas Business Centre I: 28' x 40'
- Puritas Business Centre III A & B: 25' x 40'

### TRUCK ACCESS

#### Puritas Business Centre I

- Truck docks: 4' recessed with insulated metal industrial doors and angled exterior concrete platforms
- Drive-Ins: with insulated metal industrial doors
- Personnel: 20 gauge flush hollow metal doors

#### Puritas Business Centre III A & B

- Truck docks: with insulated metal industrial doors
- Drive-Ins: insulated metal industrial doors
- Personnel: 20 gauge flush hollow metal doors

### ROOF

#### Puritas Business Centre I

- Insulated, aluminized steel standing-seam; single sloped

#### Puritas Business Centre III A & B

- 2" standing seam, 24 gauge aluminized steel, single sloped with 4" vinyl faced insulation (U=.08, R=13) supported by wire mesh

### EXTERIOR WALLS

#### Puritas Business Centre I

- 24 gauge insulated metal panels

#### Puritas Business Centre III A & B

- 8" split face block
- 3" interlocking metal panels with 3" insulation (U=.10, R=3) and pebble-grained finish

### FLOOR

- 5" reinforced concrete

### WAREHOUSE LIGHTING

- Fluorescent fixtures

### SPRINKLER SYSTEM

#### Puritas Business Centre I:

- None

#### Puritas Business Centre III A & B:

- Wet / Ordinary hazard

### HVAC

- Warehouse: gas-fired unit heater, (Heating: 60°F temperature difference at 0°F outside)
- Office: gas-fired furnace with electric air conditioner, (Heating: 68°F temperature difference at 0°F outside; Air Conditioning: 15°F temperature difference at 90°F outside)

### OFFICE AREAS

- Partitions: 5/8" drywall on 3-5/8" metal studs
- Ceiling: 2' x 4' acoustical tile on suspended T-grid system
- Floor: commercial grade carpeting and/or vinyl tile (VCT)
- Entrance Doors: glass with aluminum tubular frames
- Interior Doors: 1-3/8" flush birch doors with hardware
- Windows: insulated glass with aluminum tubular frames
- Paint: two coats of Latex on drywall; enamel on door frames
- Plumbing: surface mounted water closets and lavatories

### PARKING & DRIVES

#### Puritas Business Centre I

- Automobile Parking: asphalt
- Truck Drives / Ramps: concrete and asphalt

#### Puritas Business Centre III A & B

- Automobile Parking: 4" concrete and asphalt
- Truck Drives / Ramps: 7" concrete

### UTILITIES

- Electric: The Illuminating Co.
- Gas: Dominion East Ohio
- Telephone: AT&T
- Water: City of Cleveland
- Sanitary & Storm Sewer: City of Cleveland



# ***FOR LEASE***

8,960 Sq. Ft. Warehouse – Office  
13949 West Parkway, Cleveland, Ohio

---

## **Individual Space Specifications**

**Office Area:** 1,200 SF  
**Warehouse Area:** 7,760 SF  
**Total Area:** 8,960 SF

**Unit Number:** 13949

**Drive-in Doors:** Two (2) 12' x 14' drive-in-doors with 4' dock edge

**Eave Height:** 20'

**Column Spacing:** 20' x 40'

**Electricity:** 120/208 Volt, 600 Amp, 3 phase, 4 wire service

**Lighting:** High lumen T8 lamps and instant start, electronic ballasts:  
• Energy efficient (50% less consumption than traditional T12 lighting)  
• Only 7% luminary depreciation over the life of the bulb

**Sprinklers:** None

**Estimated Operating Costs:** \$1.78/SF/YR based upon budget expenses for 2016.

Operating cost estimates are based on Real Estate Taxes, Building Insurance, Common Area Maintenance and Property Management Fees for the year and the square footage listed above. Costs may vary in the future. Common Area Maintenance includes only the maintenance items performed by the owner for the benefit of the entire project, such as snowplowing, lawn care, backflow prevention test and general exterior maintenance, etc.



**flexible spaces**  
**all the right places.**

Mark Ray, Vice President  
216-351-7976, ext. 244  
markray@fogg.com

Tom Blaz, Leasing Associate  
216-351-7976, ext. 273  
tblaz@fogg.com

**fogg.com**

DESCRIPTION	DATE

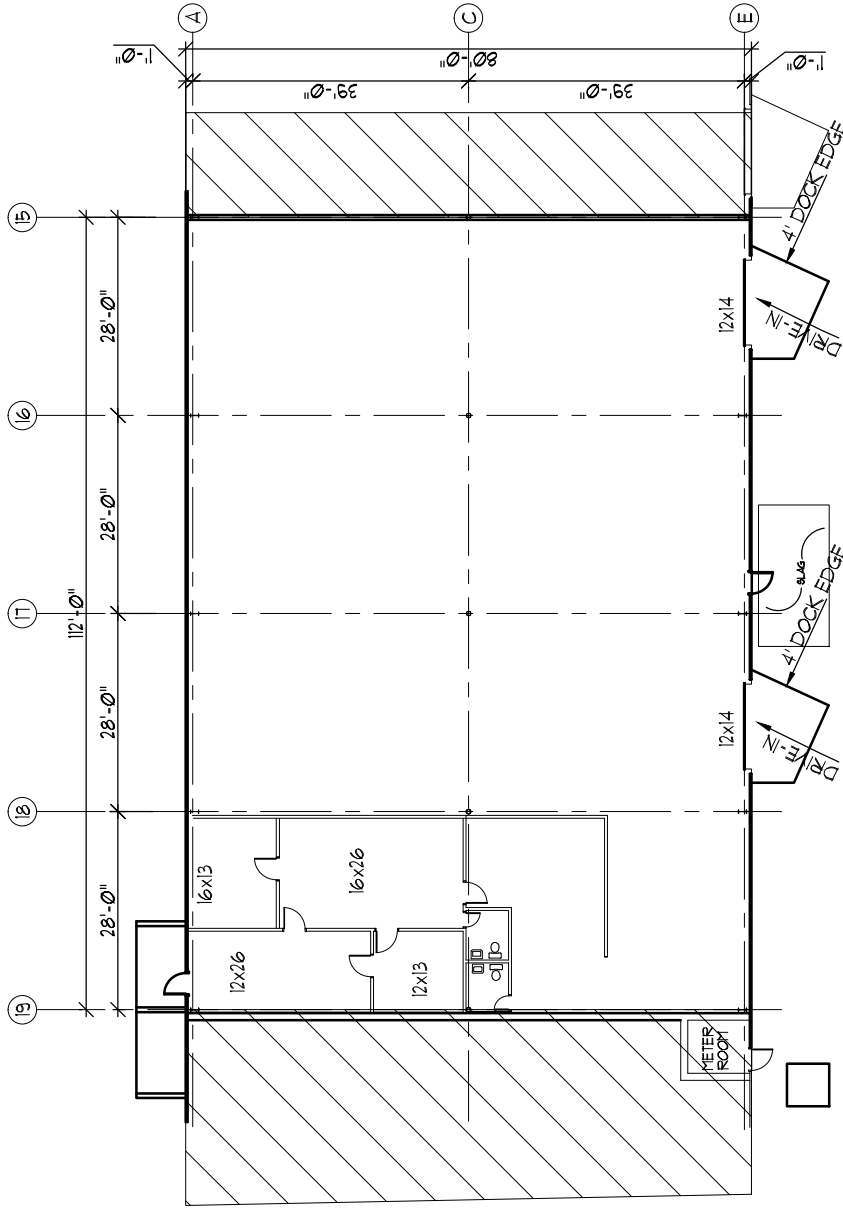

1200 SF OFFICE  
1,716 SF WHSE.  
8,960 SF TOTAL

**FLOOR PLAN**

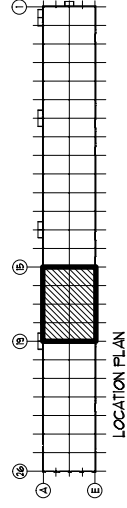

**FURTAS BUSINESS CENTRE**  
1341 WEST FAIRWAY  
CLEVELAND, OHIO



RAY FOGG REAL ESTATE  
COMMERCIAL & INDUSTRIAL  
1000 EAST 12TH STREET, SUITE 200  
CLEVELAND, OHIO 44115  
TEL: (216) 398-1000 FAX: (216) 398-1001

(216) 351-1916  
1-811-729-3644

**RAY FOGG CORPORATE PROPERTIES**  
381 KENYON CIRCLE, SUITE 15  
BROOKLYN HEIGHTS, OHIO 44131



DATE	10-25	SCALE	A-1
DWG	2005	DATE	A-1

# PURITAS BUSINESS CENTRE I

13921-13981 West Parkway

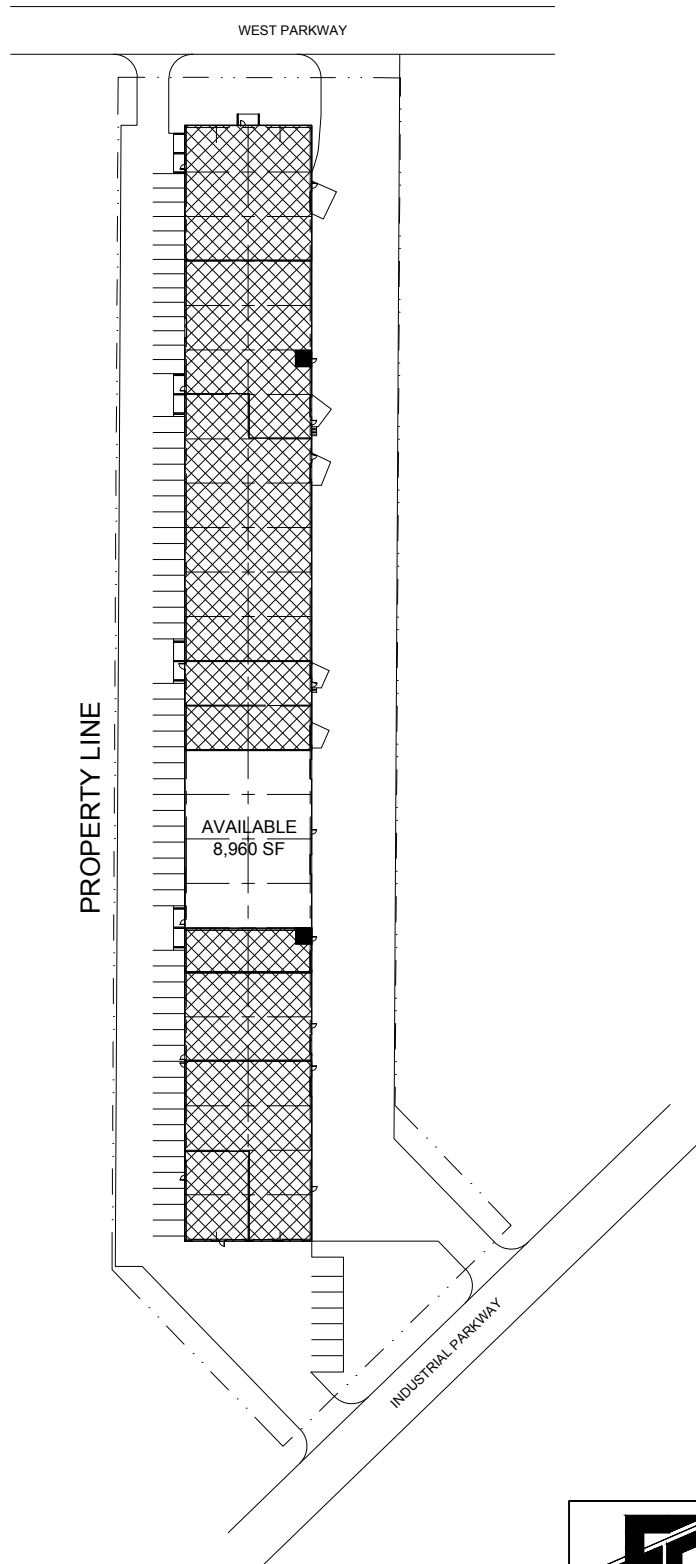
Cleveland, Ohio 44135



-  AVAILABLE
-  LEASED
-  UTILITY / METER ROOM

**FOGG**  
ENGINEERS CONTRACTORS DEVELOPERS

DRAWN BY	CHECKED	DATE	DRAWING NO.
TDG		03-02-16	PBC1