

# flexible spaces all the right places...



...Brunswick Business Centre I & II  
2774 & 2792 Nationwide Parkway



...Brunswick Business Centre III & IV  
1126 & 1130 Industrial Parkway

**“Flexible Spaces in All the Right Places”** is what Fogg had in mind when designing their large portfolio of office, industrial and office/warehouse (flex) properties. Strategically located near major freeways in northeast Ohio, Fogg’s properties offer flexible floor plans, truck access and lease terms, as well as expansion opportunities for their growing customers.

Well located near the intersection of I-71 and State Rt. 303 in Brunswick, Ohio, Fogg’s properties are within the thriving Brunswick Industrial Park. The park is located within minutes of the Ohio Turnpike I-80, I-71 and Cleveland Hopkins International Airport. These office/warehouse buildings are designed to be easily altered to fit a variety of distribution and light manufacturing uses.



“We have been a partner with Ray Fogg Corporate Properties since 2021. I say partner, and not tenant, as we both take pride and responsibility in our facility. The building is well constructed and meets all of our distribution needs. The team at Fogg is quick to respond to any issue, no matter how small, and I will tell you they have all been small. I foresee our corporation remaining with team Fogg for years to come.” **-Veritiv Corporation**

“Our company has been a tenant of Ray Fogg Corporate Properties for nearly 30 years. We’ve grown with Fogg during this time into larger spaces. The team is always responsive to our needs and easy to work with. I’ve found Fogg to be a great partner!” **-Motion Industries**



**216.351.7976**  
**fogg.com**

# STANDARD BUILDING SPECIFICATIONS

## Brunswick Business Centre I, II, III & IV

The following information is a general description of the project. Please see the Individual Space Specifications for more details on each available space.



### LOCATION & ACCESS

#### Shared Features

- Located in the Brunswick Industrial Park at the four way interchange of I-71 and Rt. 303
- Easy access to I-71, Ohio Turnpike I-80, I-271 and West 130th St.

#### Brunswick Business Centre I & II

- 6.23 acre site fronting onto West 130th St. & Nationwide Parkway in Brunswick, Ohio

#### Brunswick Business Centre III & IV

- 6.18 acre site fronting onto Industrial Parkway North and I-71 in Brunswick, Ohio

### PROPERTY DATA

• Brunswick Business Centre I:	39,360 SF
• Brunswick Business Centre II:	49,700 SF
• Brunswick Business Centre III:	40,213 SF
• Brunswick Business Centre IV:	40,213 SF

### EAVE HEIGHT

- 20'

### COLUMN SPACING

• Brunswick Business Centre I:	25' x 40'
• Brunswick Business Centre II:	25' x 50'
• Brunswick Business Centre III & IV:	25' x 40'

### TRUCK ACCESS/DOORS

- Truck docks with insulated metal industrial doors
- Drive-Ins with insulated metal industrial doors
- Personnel: 20 gauge plush hollow metal doors

### ROOF

- 2" standing seam, 24 gauge aluminized steel, single-sloped with 4" vinyl faced insulation (U = .08; R = 13)

### FLOOR

- 5" reinforced concrete

### WAREHOUSE LIGHTING

- Fluorescent fixtures (25 F.C.)

### SPRINKLER SYSTEM

- Wet / Ordinary hazard

### EXTERIOR WALLS

#### Brunswick Business Centre I & II

- 3" interlocking metal panels with 3" insulation (U = .10; R = 10) and a pebble-grained, fluoropolymer finish
- Dryvit wall systems

#### Brunswick Business Centre III & IV

- 3" interlocking metal facade panels with pebble-grained, fluoropolymer finish and 3" insulation (U=10; R=10)
- Prepainted aluminum clad Weyerhaeuser Panel 15

### HVAC

- Warehouse: gas-fired unit heater, (Heating: 60°F temperature difference at 0°F outside)
- Office: gas-fired furnace with electric air conditioner, (Heating: 68°F temperature difference at 0°F outside; Air Conditioning: 15°F temperature difference at 90°F outside)

### OFFICE AREAS

- Partitions: 5/8" drywall on 3-5/8" metal studs
- Ceiling: 2' x 4' acoustical tile on suspended T-grid System
- Floor: commercial grade carpeting or vinyl tile (V.C.T.)
- Entrance Doors: glass with aluminum tubular frames
- Interior Doors: 1-3/8" flush birch doors with hardware
- Windows: insulated glass with aluminum tubular frames
- Paint: two coats of Latex on drywall; enamel on door frames
- Plumbing: surface mounted water closet and lavatory

### PARKING & DRIVES

- Automobile Parking: 4" concrete
- Truck Drives / Ramps: 7" concrete in truck drives and docks

### UTILITIES

- Electric: Ohio Edison
- Gas: Columbia Gas of Ohio
- Telephone: Verizon
- Water: City of Cleveland (main - 12")
- Sanitary Sewer: City of Brunswick (main - 10")
- Storm Sewer: Medina County



216.351.7976  
fogg.com

***FOR LEASE***  
**6,000 Sq. Ft. Warehouse**  
**2774 Nationwide Parkway, Brunswick, Ohio**

---

**Individual Space Specifications**

**Office Area:** 252 SF  
**Warehouse Area:** 5,748 SF  
**Total Area:** 6,000 SF

**Unit Number:** 10

**Truck Dock:** One (1) with an 8' x 8' dock door

**Drive-in Doors:** One (1) 10' x 12'

**Eave Height:** 20'

**Column Spacing:** 25' x 40'

**Electricity:** 120/208 Volt, 400 Amp, 3 phase, 4 wire service

**Lighting:** High lumen T8 lamps and instant start, electronic ballasts:  
• Energy efficient (50% less consumption than traditional T12 lighting)  
• Only 7% luminary depreciation over the life of the bulb

**Sprinklers:** Wet / Ordinary Hazard

**Estimated Operating Costs:** \$2.43/SF/YR based upon budget costs for 2026.

Operating cost estimates are based on Real Estate Taxes, Building Insurance, Common Area Maintenance and Property Management Fees for the year and the square footage listed above. Costs may vary in the future. Common Area Maintenance includes only the maintenance items performed by the owner for the benefit of the entire project, such as snowplowing, lawn care, backflow



**flexible spaces**  
**all the right places.**

Tom Blaz, Vice President  
216-351-7976, ext. 273  
tblaz@fogg.com

Mark Ray, Chief Operating Officer  
216-351-7976, ext. 244  
markray@fogg.com

**fogg.com**

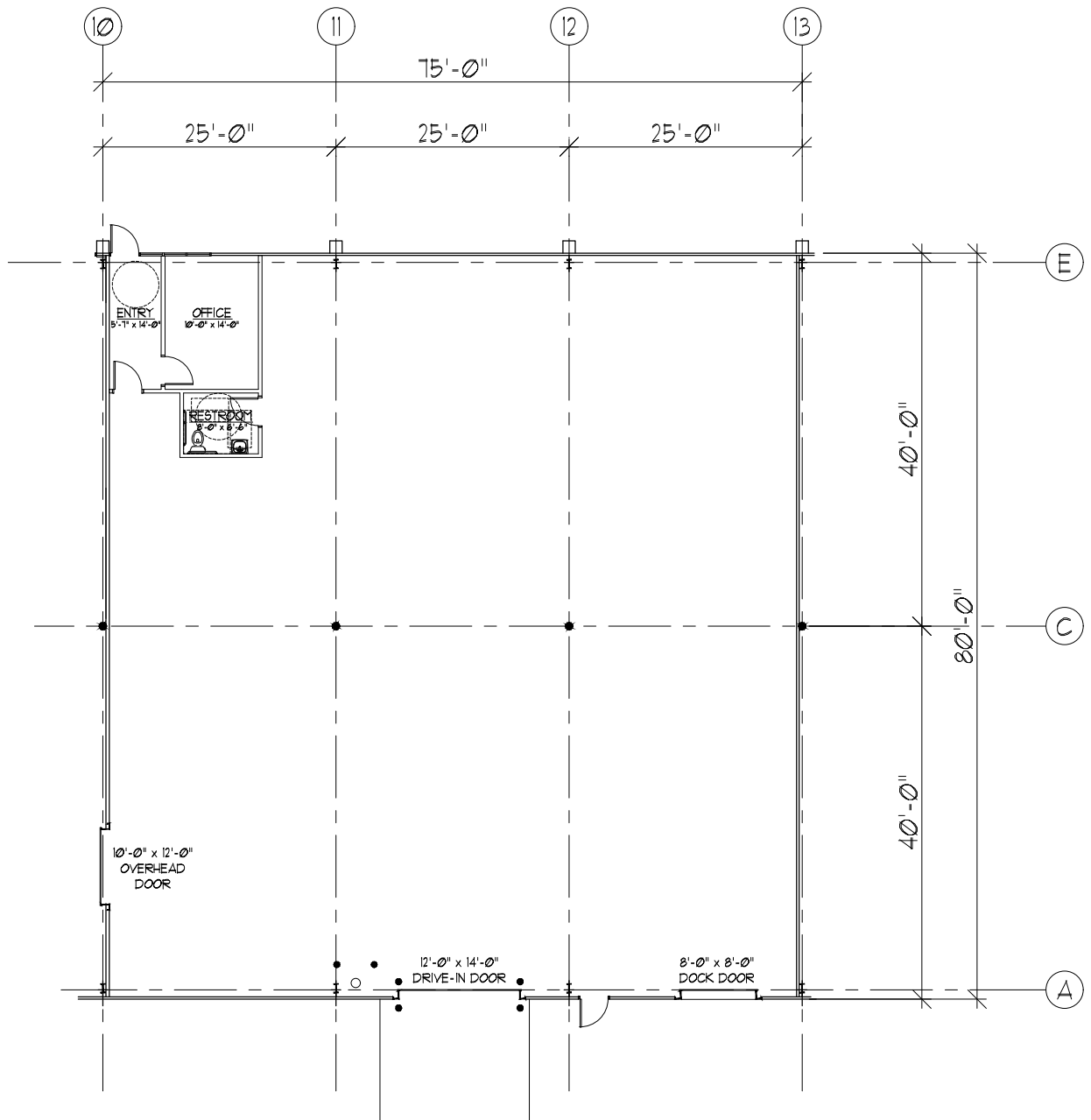

FLOOR PLAN

TOTAL AREA = 6,000 SF

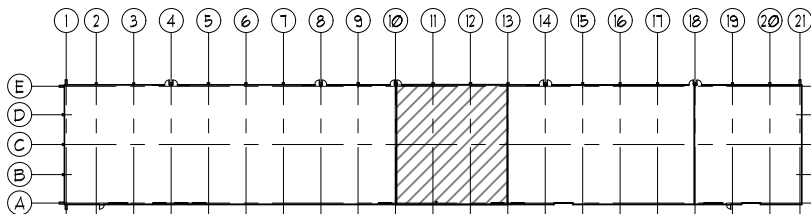

KEY PLAN  
BAYS 10-13

BRUNSWICK BUSINESS CENTRE 1  
2114 NATIONWIDE PARKWAY  
BRUNSWICK, OHIO

RAY FOGG CORPORATE PROPERTIES, LLC  
981 KEYNOTE CIRCLE, SUITE 15  
BROOKLYN HEIGHTS, OHIO

(216) 351-7976  
1-877-729-3644

**RAY FOGG BUILDING METHODS, INC.**  
185 KENNEDY ROAD, SUITE 16, BROOKLYN, OHIO 44139  
PHONE (216) 882-9979

DESIGNED BY	DRAWN BY	DATE	CONTRACT NO.	FIG. NO.
TDG	-	5-14-2016		A-1