

# flexible spaces all the right places...



...Brunswick Business Centre I & II  
2774 & 2792 Nationwide Parkway



...Brunswick Business Centre III & IV  
1126 & 1130 Industrial Parkway

**“Flexible Spaces in All the Right Places”** is what Fogg had in mind when designing their large portfolio of office, industrial and office/warehouse (flex) properties. Strategically located near major freeways in northeast Ohio, Fogg’s properties offer flexible floor plans, truck access and lease terms, as well as expansion opportunities for their growing customers.

Well located near the intersection of I-71 and State Rt. 303 in Brunswick, Ohio, Fogg’s properties are within the thriving Brunswick Industrial Park. The park is located within minutes of the Ohio Turnpike I-80, I-71 and Cleveland Hopkins International Airport. These office/warehouse buildings are designed to be easily altered to fit a variety of distribution and light manufacturing uses.

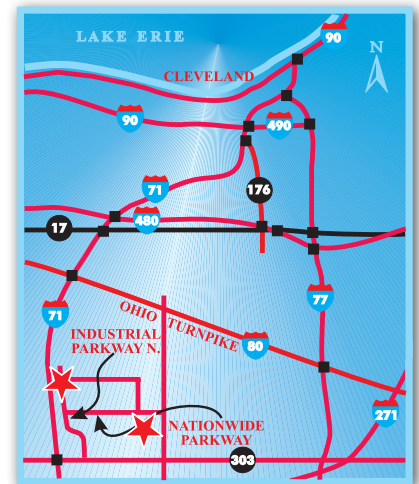

“The entire Fogg team provided tremendous cooperation during the leasing and construction of our new corporate headquarters and high bay distribution center. We are completely satisfied with the building and with the support that we’ve received from Fogg since we moved into our new facility” - Guardian Technologies



216.351.7976  
[fogg.com](http://fogg.com)

# STANDARD BUILDING SPECIFICATIONS

## Brunswick Business Centre I, II, III & IV

The following information is a general description of the project. Please see the Individual Space Specifications for more details on each available space.



### LOCATION & ACCESS

#### Shared Features

- Located in the Brunswick Industrial Park at the four way interchange of I-71 and Rt. 303
- Easy access to I-71, Ohio Turnpike I-80, I-271 and West 130th St.

#### Brunswick Business Centre I & II

- 6.23 acre site fronting onto West 130th St. & Nationwide Parkway in Brunswick, Ohio

#### Brunswick Business Centre III & IV

- 6.18 acre site fronting onto Industrial Parkway North and I-71 in Brunswick, Ohio

### PROPERTY DATA

- Brunswick Business Centre I: 39,360 SF
- Brunswick Business Centre II: 49,700 SF
- Brunswick Business Centre III: 40,213 SF
- Brunswick Business Centre IV: 40,213 SF

### EAVE HEIGHT

- 20'

### COLUMN SPACING

- Brunswick Business Centre I: 25' x 40'
- Brunswick Business Centre II: 25' x 50'
- Brunswick Business Centre III & IV: 25' x 40'

### TRUCK ACCESS/DOORS

- Truck docks with insulated metal industrial doors
- Drive-Ins with insulated metal industrial doors
- Personnel: 20 gauge plush hollow metal doors

### ROOF

- 2" standing seam, 24 gauge aluminized steel, single-sloped with 4" vinyl faced insulation (U = .08; R = 13)

### FLOOR

- 5" reinforced concrete

### WAREHOUSE LIGHTING

- Fluorescent fixtures (25 F.C.)

### SPRINKLER SYSTEM

- Wet / Ordinary hazard

### EXTERIOR WALLS

#### Brunswick Business Centre I & II

- 3" interlocking metal panels with 3" insulation (U = .10; R = 10) and a pebble-grained, fluoropolymer finish
- Dryvit wall systems

#### Brunswick Business Centre III & IV

- 3" interlocking metal facade panels with pebble-grained, fluoropolymer finish and 3" insulation (U=10; R=10)
- Prepainted aluminum clad Weyerhaeuser Panel 15

### HVAC

- Warehouse: gas-fired unit heater, (Heating: 60°F temperature difference at 0°F outside)
- Office: gas-fired furnace with electric air conditioner, (Heating: 68°F temperature difference at 0°F outside; Air Conditioning: 15°F temperature difference at 90°F outside)

### OFFICE AREAS

- Partitions: 5/8" drywall on 3-5/8" metal studs
- Ceiling: 2' x 4' acoustical tile on suspended T-grid System
- Floor: commercial grade carpeting or vinyl tile (V.C.T.)
- Entrance Doors: glass with aluminum tubular frames
- Interior Doors: 1-3/8" flush birch doors with hardware
- Windows: insulated glass with aluminum tubular frames
- Paint: two coats of Latex on drywall; enamel on door frames
- Plumbing: surface mounted water closet and lavatory

### PARKING & DRIVES

- Automobile Parking: 4" concrete
- Truck Drives / Ramps: 7" concrete in truck drives and docks

### UTILITIES

- Electric: Ohio Edison
- Gas: Columbia Gas of Ohio
- Telephone: Verizon
- Water: City of Cleveland (main - 12")
- Sanitary Sewer: City of Brunswick (main - 10")
- Storm Sewer: Medina County

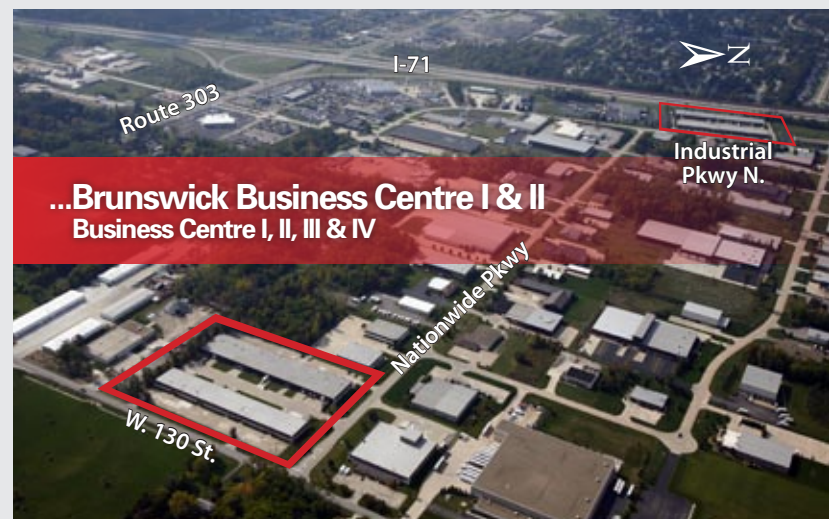

216.351.7976  
fogg.com

NO.	DESCRIPTION	DATE

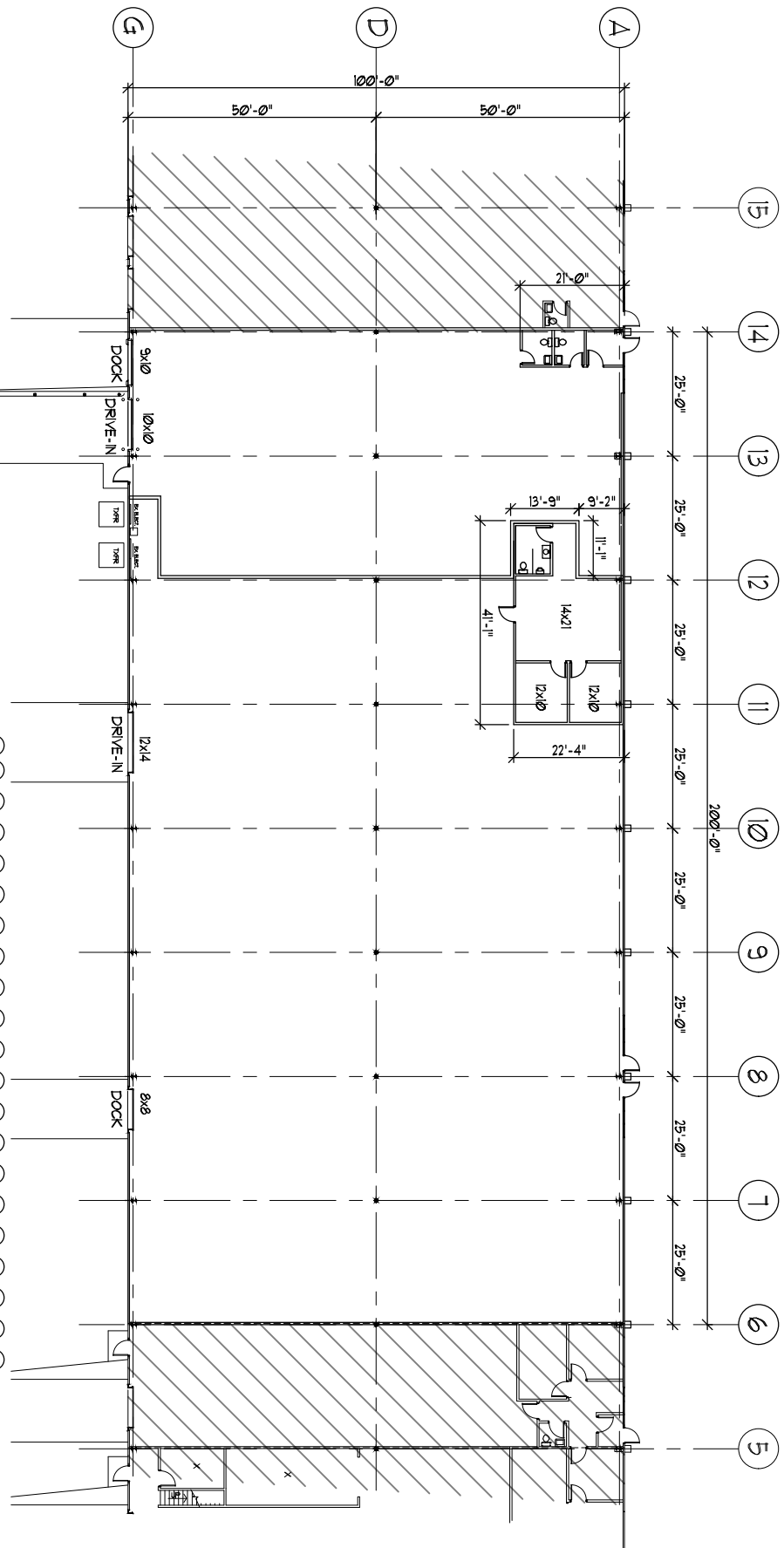

OFFICE AREA = 911 SF  
 WAREHOUSE AREA = 19,079 SF  
 TOTAL AREA = 20,000 SF

**FLOOR PLAN**

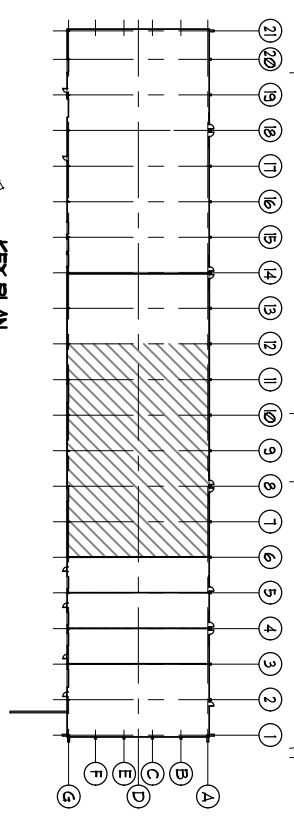

**KEY PLAN**  
 FRAMES 6-14

**BRANSWICK BUSINESS CENTER 2**  
 2792 NATIONALIDE PARKWAY  
 BRANSWICK, OHIO



**RAY FOGG CORPORATE PROPERTIES, LLC**  
 981 KENNOTE CIRCLE, SUITE 15  
 BROOKLYN HEIGHTS, OHIO

(216) 351-1916  
 1-877-729-3644

PROJECT NO.	106	DATE	10/2014
DRAWN BY	AJ	CHECKED BY	
SCALE	1"=6'	PROJECT NO.	106
DATE		SCALE	

# ***FOR LEASE***

20,000 Sq. Ft. Warehouse – Office  
2792 Nationwide Parkway, Brunswick, Ohio

---

## **Individual Space Specifications**

<b>Total Area:</b>	971 SF Office <u>19,029 SF</u> Warehouse 20,000 SF Total
<b>Unit Number:</b>	12
<b>Truck Docks:</b>	Two (2) with an 8' x 8' overhead door Two (2) drive-in door 12' x 14'
<b>Eave Height:</b>	20'
<b>Column Spacing:</b>	25' x 50'
<b>Electricity:</b>	480/277 100 amp service and 480/277 400 amp service 120/208 Volt, 100 Amp , 3 phase, 4 wire service
<b>Lighting:</b>	High lumen T8 lamps and instant start, electronic ballasts: <ul style="list-style-type: none"><li>• Energy efficient (50% less consumption than traditional T12 lighting)</li><li>• Only 7% luminary depreciation over the life of the bulb</li></ul>
<b>Sprinklers:</b>	Wet / Ordinary Hazard
<b>Estimated Operating Costs:</b>	\$2.00/SF/YR based upon budget costs for 2024.

Operating cost estimates are based on Real Estate Taxes, Building Insurance, Common Area Maintenance and Property Management Fees for the year and the square footage listed above. Costs may vary in the future. Common Area Maintenance includes only the maintenance items performed by the owner for the benefit of the entire project, such as snowplowing, lawn care, backflow prevention test and general exterior



**flexible spaces**  
**all the right places.**

Mark Ray, Vice President  
216-351-7976, ext. 244  
markray@fogg.com

Tom Blaz, Director of Leasing & Sales  
216-351-7976, ext. 273  
tblaz@fogg.com

**fogg.com**